



**FORK ATTACHMENT · LONG-GOODS & HEAVY-LIFT HANDLING**

# **SECURE HANDLING OF UNWIELDY LOADS. FOR FORKLIFTS 3 – 35 T.**

The ELM Load Stabiliser (LS) gives operators a unique way to hold on to long, awkward cargo — pipes, tubes, beams, bundled goods — under difficult conditions. Five models cover forklift capacities from 3 up to 35 tonnes; each mounts on the truck's existing forks or factory-fits on an e-l-m fork positioner.



## THE PROBLEM · THE SOLUTION

## HOLD ON TO WHAT THE FORKS ALONE CAN'T.

Long, cylindrical or bundled loads — steel pipes, tubes, timber, profiles — are difficult to move safely on conventional forks. A sudden movement, a slope, or uneven ground is enough to make the load roll or shift. The ELM Load Stabiliser holds the load down against the forks, so the operator can transport it with confidence, even over rough terrain.

The LS is used across industries where long goods are handled every day. It is an obvious choice in the oil and gas industry, where ELM stabilisers handle extremely long pipes worldwide, but it applies equally to steel service centres, construction, shipyards, and timber yards.

The clamping arm follows the dynamic deflection of the fork to keep a secure grip on the outer load. Rubber fenders protect the cargo from scratches. A hydraulic accumulator absorbs shocks so the clamping pressure stays constant while the truck moves.

### MOUNTING OPTIONS

The LS can be fitted to **existing forks** with a retaining plate, or delivered **pre-fitted on an e-l-m fork positioner** — typically combined with the integrated fork positioner with side shift (IFPF) for maximum flexibility on a single carriage.



### ADVANTAGES

- High level of safety when transporting pipes and other long goods
- Applicable across many industries
- Mountable on existing forks or on a fork positioner
- Holding arm follows the dynamic movement of the fork
- For forklifts with capacities from 3 to 35 tonnes



FIVE MODELS · FOR FORKLIFTS 3 – 35 T

## TECHNICAL DATA

### ATTACHMENT OVERVIEW

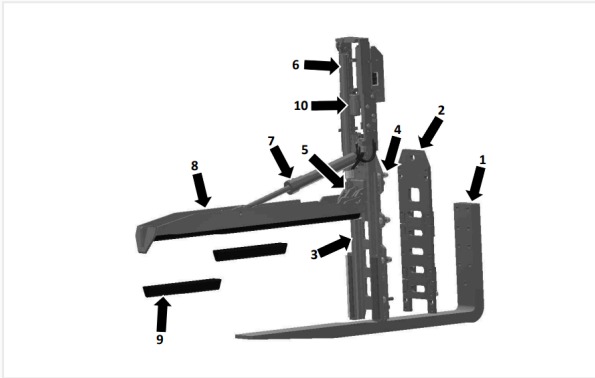

- |                     |                           |
|---------------------|---------------------------|
| 1. Original fork    | 6. Vertical cylinder      |
| 2. Mounting plate   | 7. Tilt cylinder          |
| 3. Main frame       | 8. Arm                    |
| 4. Frame screw      | 9. Fender (rubber)        |
| 5. Cylinder console | 10. Hydraulic accumulator |

### DIMENSIONAL DRAWINGS

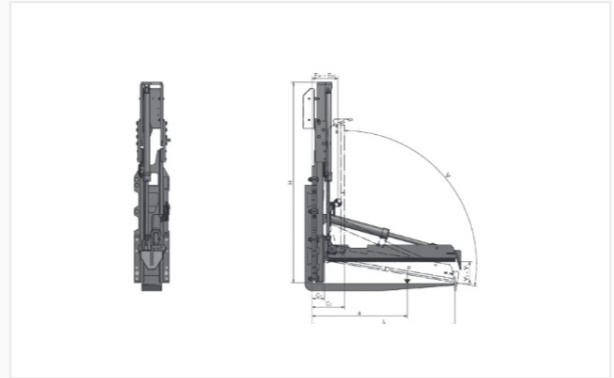

Side profile and operating envelope.  $H$  = height ·  $A$  = width ·  $L$  = fork length ·  $V$  = tilt angle ·  $C_1, C_2$  = load-centre references.

MODEL	MAX CAP. P (KG)	LOAD C. A (MM)	HEIGHT H (MM)	WIDTH A (MM)	FORK LENGTH $L_{MIN}-L_{MAX}$ (MM)	ANGLE V (°)	OPENING $Y_1-Y_2$ (MM)	COG HORIZ. $E_{MIN}-E_{MAX}$ (MM)	WEIGHT Q (KG)
2LS 3/500 – 1200-L	5 000	500	1 440	210*	1 200 – 2 000	94	0 – 450	182 – 86	390
2LS 6/600 – 1500	12 000	600	1 790	310*	1 200 – 2 400	102	50 – 600	279 – 114	700
2LS 12/600 – 1600	22 000	600	2 420	360*	1 600 – 2 500	102	100 – 900	247 – 121	1 100
2LS 20/1200 – 1800	25 000	1 200	2 510	440*	1 800 – 3 000	102	100 – 900	288 – 126	1 600
3LS 35/1200 – 2000	35 000	1 200	2 420	540*	2 000 – 3 000	102	100 – 900	298 – 162	2 240

### HYDRAULIC REQUIREMENTS

MODEL	MIN. FLOW (L/MIN)	RECOMMENDED (L/MIN)	MAX. FLOW (L/MIN)	MAX. PRESSURE (BAR)
LS3	12	25	27	200
LS6 – LS35	20	25 – 35	38	200

Required functions: 1 hydraulic + 1 electric, or 2 hydraulic. Hose diameters must be identical on left and right arms for synchronous operation.

- \* Width A is indicative — exact values depend on configuration.
- Delivered without forks. Hoses between the central hydraulic unit and the LS are not included.

### OPERATING ENVIRONMENT

Recommended average temperature **+25 °C**.  
Minimum **-20 °C**, maximum **+40 °C**.

Not suited for cold-storage facilities, ATEX (potentially explosive) environments, or corrosive environments (coastal saltwater, acids, alkaline goods). Non-serial versions available on request.



FIT IT · RUN IT · KEEP IT RUNNING

## INSTALLATION & SERVICE

### INSTALLATION

- Mountable on the existing forks of the forklift using a retaining plate, or pre-fitted on an e-l-m fork positioner.
- Often combined with the integrated fork positioner with side shift (IFPF) for a single, flexible carriage.
- Welding of the mounting plate must be performed by a certified welder according to the supplied Welding Procedure Specification (WPS).
- Delivered without forks. Hoses between the truck's central hydraulic unit and the LS are not supplied.

### SERVICE INTERVALS

- **Daily:** visual inspection, clean as needed.
- **Every 200 h / monthly:** lubricate bearings and sliding surfaces with DIN 51502 KP2K-30 grease; retighten bolts.
- **Every 1 200 h / annually:** inspect mounting plate welds, forks (per ISO 5057), hydraulic hoses, cylinder seals.
- Declaration of Conformity: Machinery Directive 2006/42/EC. Harmonised standards EN/ISO 12100, EN/ISO 3691-1, ISO 2328.



### FORKLIFTCENTER B.V.

#### Visiting address

Hornweg 18  
1045 AR Amsterdam  
The Netherlands

#### Postal address

PO Box 20595  
1001 NN Amsterdam

#### Tel.

+31 (0)20 497 4101

#### Fax

+31 (0)20 497 4865

